

## (鋼製)燈槽 STEEL RACEWAY

### INDEX

DESCRIPTION	PAGE
直式線槽 (STRAIGHT RACEWAY)	2
水平L形彎頭 (HORIZONTAL 90° ELBOW)	2
水平T形彎頭 (HORIZONTAL TEE ELBOW)	2
水平X形彎頭 (HORIZONTAL CROSS ELBOW)	2
垂直上升彎頭 (VERTICAL INSIDE ELBOW)	3
垂直下降彎頭 (VERTICAL OUTSIDE ELBOW)	3
線槽連接片 (CONNECTOR)	4
終端封板 (BLIND END COVER)	4
配電盤連接片 (PANEL PLATE CONNECTOR)	4
線槽吊環 (HANGER CLAMP)	4
彎頭蓋板固定夾 (ELBOW COVER CLAMP)	5
馬車螺絲 (SQUARE NECK BOLT)	5



-  直式線槽 (STRAIGHT RACEWAY)
-  水平L形彎頭 (HORIZONTAL 90° ELBOW)
-  水平T形彎頭 (HORIZONTAL TEE ELBOW)
-  水平X形彎頭 (HORIZONTAL CROSS ELBOW)

### 1 直式線槽 (STRAIGHT RACEWAY)

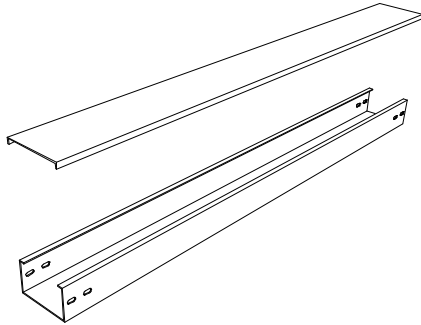

線槽材質：熱軋鋼板，厚度：2.0±0.2mm  
 蓋板材質：熱軋鋼板，厚度：2.0±0.2mm  
 表面處理：粉體塗裝  
 公差範圍：長(L)±3mm，寬(W)±2mm，高(H)±1mm  
 MATERIAL: HOT ROLLED MILD STEEL SHEET  
 FINISH: POWDER COATING  
 TOLERANCE: Length±3mm, Width±2mm, Height±1mm

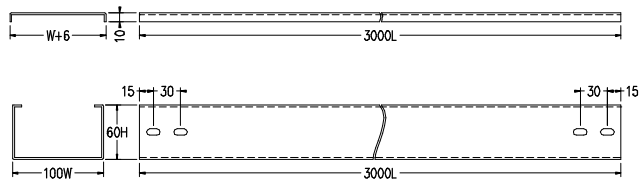

### 2 水平L形 90° 彎頭 (HORIZONTAL 90° ELBOW)

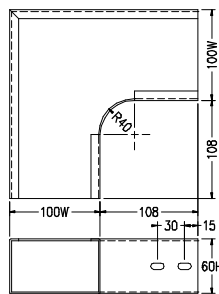
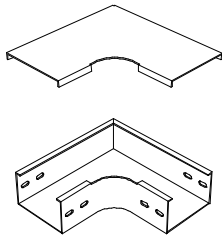

線槽本體

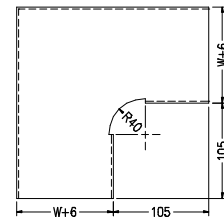

線槽蓋板

### 3 水平T形彎頭 (HORIZONTAL TEE ELBOW)

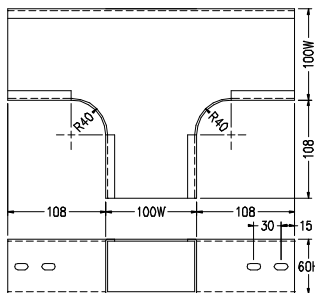
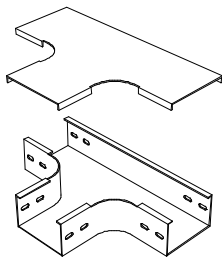

線槽本體

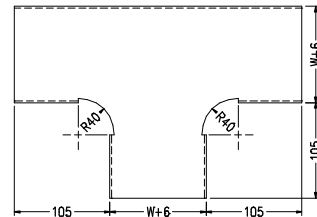

線槽蓋板

### 4 水平X形彎頭 (HORIZONTAL CROSS ELBOW)

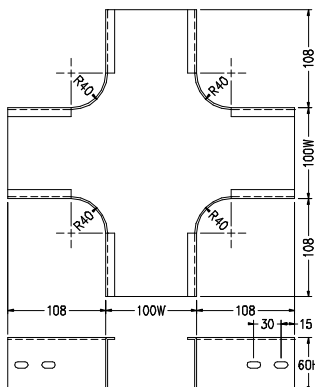
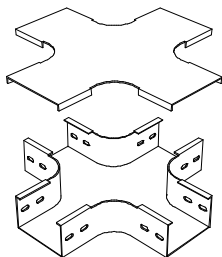

線槽本體

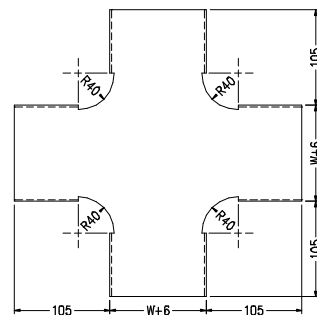

線槽蓋板

-  垂直上升 90° 彎頭 (VERTICAL INSIDE 90° ELBOW)
-  垂直上升 45° 彎頭 (VERTICAL INSIDE 45° ELBOW)
-  垂直下降 90° 彎頭 (VERTICAL OUTSIDE 90° ELBOW)
-  垂直下降 45° 彎頭 (VERTICAL OUTSIDE 45° ELBOW)

**1** 垂直上升 90° 彎頭 (VERTICAL INSIDE 90° ELBOW)

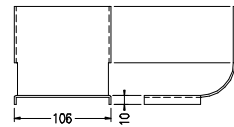
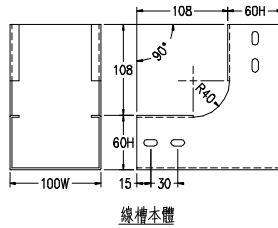
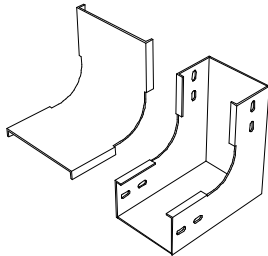

線槽蓋板

**2** 垂直上升 45° 彎頭 (VERTICAL INSIDE 90° ELBOW)

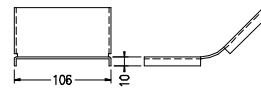
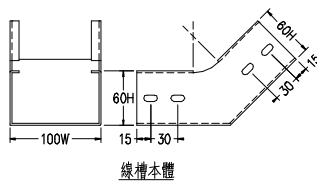
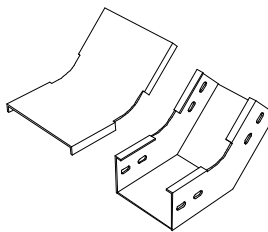

線槽蓋板

**3** 垂直下降 90° 彎頭 (VERTICAL OUTSIDE 90° ELBOW)

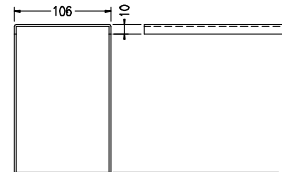
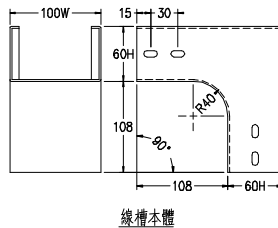
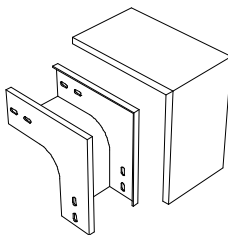

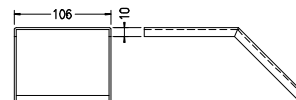
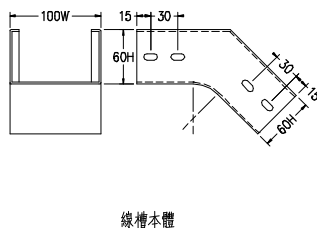
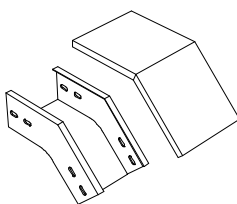

線槽蓋板

**4** 垂直下降 45° 彎頭 (VERTICAL OUTSIDE 90° ELBOW)

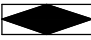

線槽蓋板

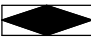
-  線槽連接片 (CONNECTOR)
-  終端封板 (BLIND END COVER)
-  配電盤連接片 (PANEL PLATE CONNECTOR)
-  線槽吊環 (HANGER CLAMP)

**1** 線槽連接片 (CONNECTOR)

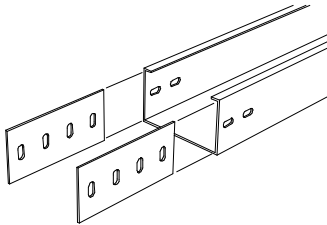

材質：熱軋鋼板  
 厚度 (t)：2.0±0.2mm  
 表面處理：粉體塗裝  
 MATERIAL: HOT ROLLED MILD STEEL SHEET  
 THICKNESS: 2.0±0.2mm  
 FINISH: POWDER COATING

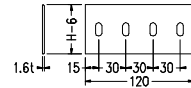

**2** 終端封板 (BLIND END COVER)

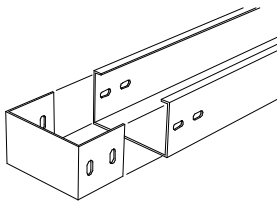

材質：熱軋鋼板  
 厚度 (t)：2.0±0.2mm  
 表面處理：粉體塗裝  
 MATERIAL: HOT ROLLED MILD STEEL SHEET  
 THICKNESS: 2.0±0.2mm  
 FINISH: POWDER COATING

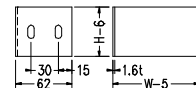
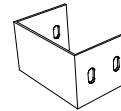

**3** 配電盤連接片 (PANEL PLATE CONNECTOR)

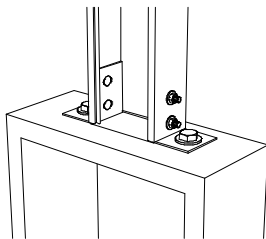

材質：熱軋鋼板  
 厚度 (t)：2.0±0.2mm  
 表面處理：粉體塗裝  
 MATERIAL: HOT ROLLED MILD STEEL SHEET  
 THICKNESS: 2.0±0.2mm  
 FINISH: POWDER COATING

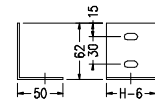

**4** 線槽吊環 (HANGER CLAMP)

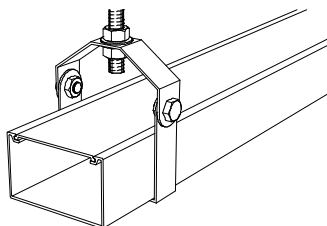

材質：熱軋鋼板  
 厚度 (t)：2.0±0.2mm  
 表面處理：粉體塗裝  
 MATERIAL: HOT ROLLED MILD STEEL SHEET  
 THICKNESS: 2.0±0.2mm  
 FINISH: POWDER COATING

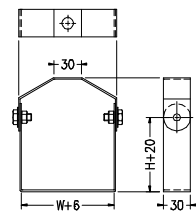
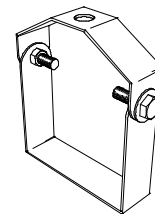

 彎頭蓋板固定夾 (ELBOW COVER CLAMP)

 馬車螺絲 (SQUARE NECK BOLT)

**1** 彎頭蓋板固定夾 (ELBOW COVER CLAMP)

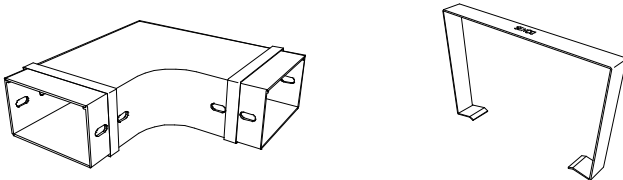

材質: 不銹鋼板 SUS304  
厚度 (t): 0.4mm  
MATERIAL: STAINLESS STEEL SUS304  
THICKNESS: 0.4mm

**2** 馬車螺絲 (SQUARE NECK BOLT)

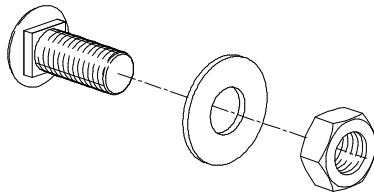

材質: 不銹鋼 SUS304  
尺寸: 1/4"x5/8"L  
MATERIAL: STAINLESS STEEL SUS304  
DIMENSION: 1/4"x5/8"L