

鋁製密閉型電纜線槽 ALUMINUM SOLID BOTTOM TYPE CABLE TRAY

INDEX

DESCRIPTION	PAGE
直式線槽 (STRAIGHT CABLE TRAY)	2
水平L形90°彎頭 (HORIZONTAL 90° ELBOW)	3
水平L形45°彎頭 (HORIZONTAL 45° ELBOW)	4
水平T形彎頭 (HORIZONTAL TEE ELBOW)	5
水平X形彎頭 (HORIZONTAL CROSS ELBOW)	6
垂直上升90°彎頭 (VERTICAL INSIDE 90° ELBOW)	7
垂直上升45°彎頭 (VERTICAL INSIDE 45° ELBOW)	8
垂直下降90°彎頭 (VERTICAL OUTSIDE 90° ELBOW)	9
垂直下降45°彎頭 (VERTICAL OUTSIDE 45° ELBOW)	10
左偏異徑接頭 (LEFT REDUCER ELBOW)	11
右偏異徑接頭 (RIGHT REDUCER ELBOW)	12
中間異徑接頭 (CENTER REDUCER ELBOW)	13
終端封板 (BLIND END COVER)	14
線槽連接片 (STRAIGHT TRAY CONNECTOR)	14
垂直可調連接片 (ADJUSTABLE VERTICAL CONNECTOR)	14
接地銅片 (COPPER GROUNDING PEICES)	14
蓋板固定夾 (COVER CLAMP)	15
馬車螺絲 (SQUARE NECK BOLT)	15
塑膠夾板 (PLASTIC CUP)	15

直式線槽 (STRAIGHT CABLE TRAY)

2 直式線槽蓋板 (STRAIGHT CABLE TRAY COVER)

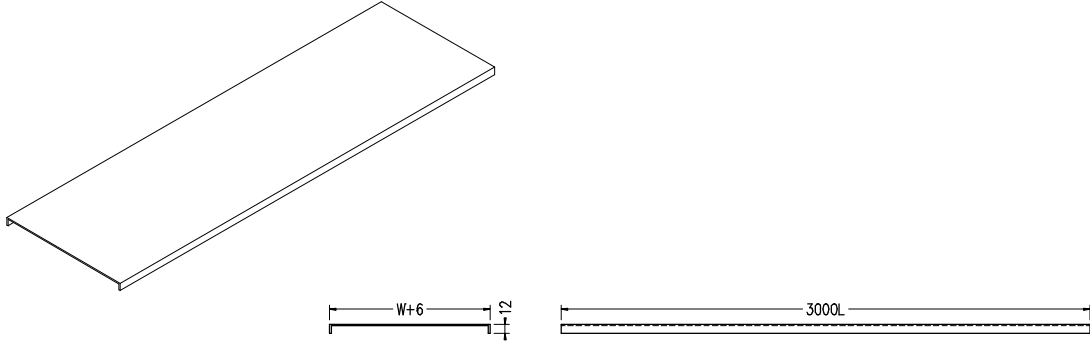

1 直式線槽 (STRAIGHT CABLE TRAY)

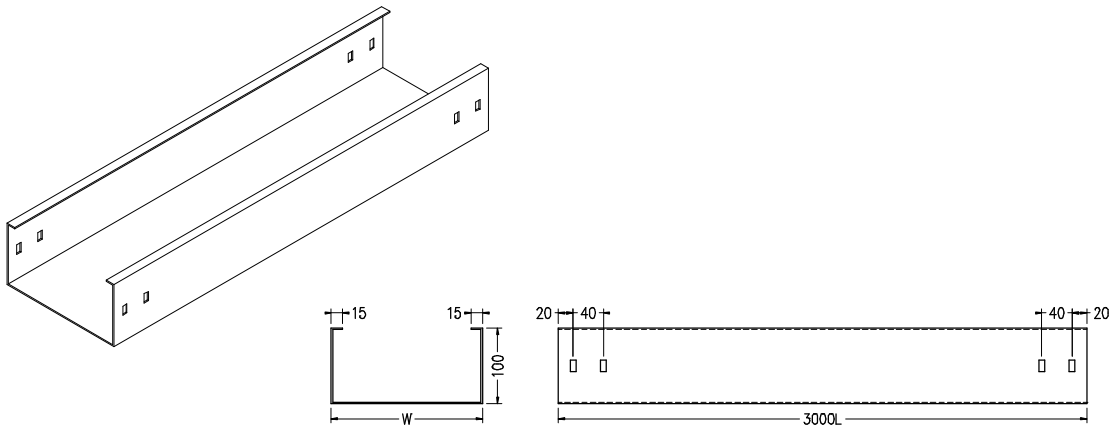

寬度 (W)	高度 (H)	長度 (L)
100	100	3000
200		
300		
400		
500		
600		
700		
800		
900		
1000		

線槽材質：鋁合金 1050，厚度：2.0mm
 蓋板材質：鋁合金 1050，厚度：2.0mm
 表面處理：陽極處理
 公差範圍：長(L)±3mm，寬(W)±2mm，高(H)±2mm，厚(t)±0.1mm
 TRAY MATERIAL: ALUMINUM ALLOYS 1050, THICKNESS: 2.0mm
 COVER MATERIAL: ALUMINUM ALLOYS 1050, THICKNESS: 2.0mm
 FINISH: ALUMINUM ANODIC TREATMENT
 TOLERANCE: Length±3mm, Width±2mm, Height±2mm, Thickness±0.1mm

水平L形 90° 彎頭 (HORIZONTAL 90° ELBOW)

1 水平L形 90° 彎頭 (HORIZONTAL 90° ELBOW)

2 水平L形 90° 彎頭蓋板 (HORIZONTAL 90° ELBOW COVER)

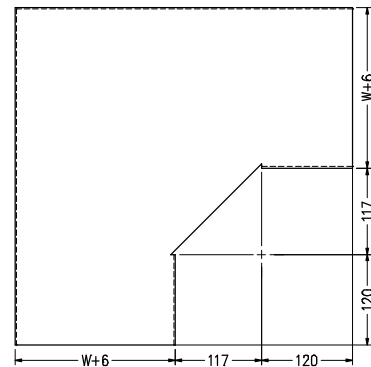
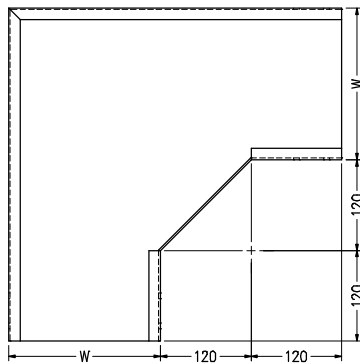
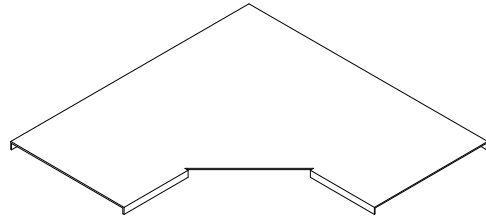
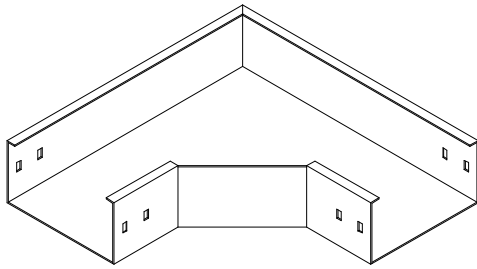

寬度 (W)	高度 (H)	半徑 (R)
100	100	120
200		
300		
400		
500		
600		
700		
800		
900		
1000		

線槽材質：鋁合金 1050，厚度：2.0mm
 蓋板材質：鋁合金 1050，厚度：2.0mm
 表面處理：陽極處理
 公差範圍：長(L)±3mm，寬(W)±2mm，高(H)±2mm，厚(t)±0.1mm
 TRAY MATERIAL: ALUMINUM ALLOYS 1050, THICKNESS: 2.0mm
 COVER MATERIAL: ALUMINUM ALLOYS 1050, THICKNESS: 2.0mm
 FINISH: ALUMINUM ANODIC TREATMENT
 TOLERANCE: Length±3mm, Width±2mm, Height±2mm, Thickness±0.1mm

◆ 水平L形 45° 彎頭 (HORIZONTAL 45° ELBOW)

1 水平L形 45° 彎頭 (HORIZONTAL 45° ELBOW)

2 水平L形 45° 彎頭蓋板 (HORIZONTAL 45° ELBOW COVER)

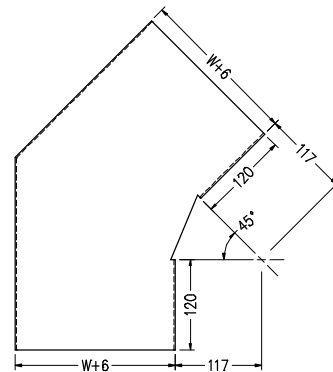
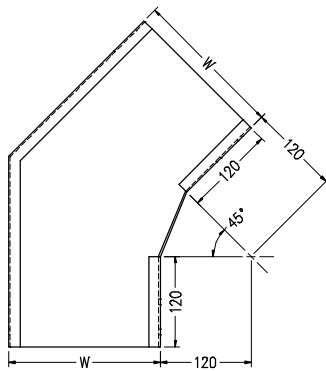
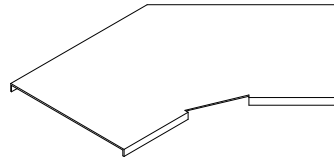
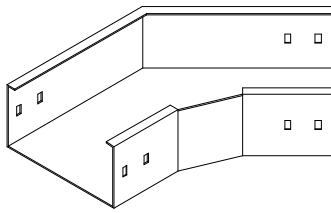

寬度 (W)	高度 (H)	半徑 (R)
100	100	120
200		
300		
400		
500		
600		
700		
800		
900		
1000		

線槽材質：鋁合金 1050, 厚度：2.0mm

蓋板材質：鋁合金 1050, 厚度：2.0mm

表面處理：陽極處理

公差範圍：長(L)±3mm, 寬(W)±2mm, 高(H)±2mm, 厚(t)±0.1mm

TRAY MATERIAL: ALUMINUM ALLOYS 1050, THICKNESS: 2.0mm

COVER MATERIAL: ALUMINUM ALLOYS 1050, THICKNESS: 2.0mm

FINISH: ALUMINUM ANODIC TREATMENT

TOLERANCE: Length±3mm, Width±2mm, Height±2mm, Thickness±0.1mm

◆ 水平T形彎頭 (HORIZONTAL TEE ELBOW)

1 水平T形彎頭 (HORIZONTAL TEE ELBOW)

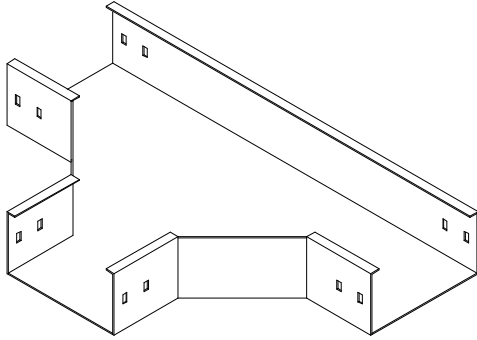

2 水平T形彎頭蓋板 (HORIZONTAL TEE ELBOW COVER)

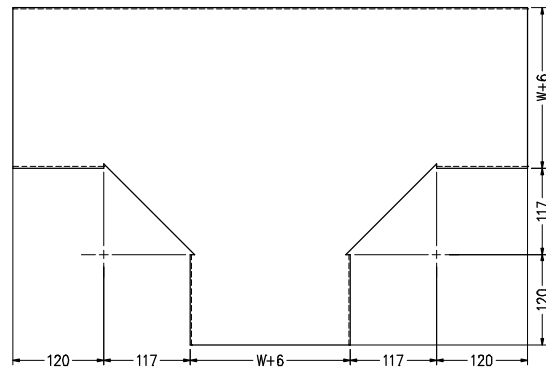
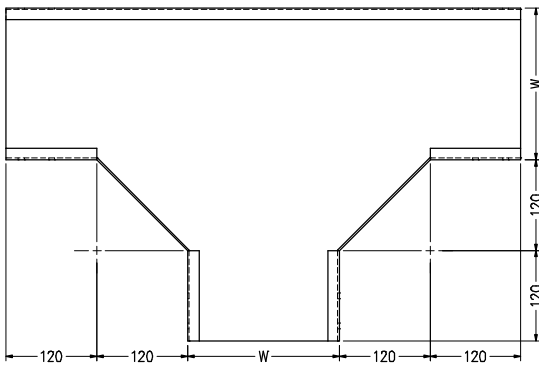
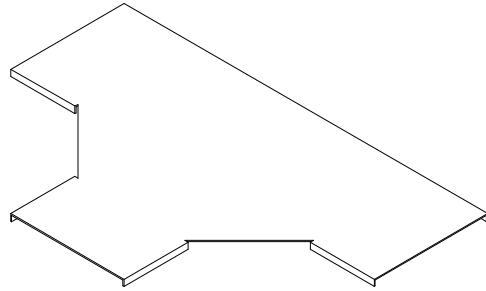

寬度 (W)	高度 (H)	半徑 (R)
100	100	120
200		
300		
400		
500		
600		
700		
800		
900		
1000		

線槽材質：鋁合金 1050，厚度：2.0mm

蓋板材質：鋁合金 1050，厚度：2.0mm

表面處理：陽極處理

公差範圍：長(L)±3mm，寬(W)±2mm，高(H)±2mm，厚(t)±0.1mm

TRAY MATERIAL: ALUMINUM ALLOYS 1050, THICKNESS: 2.0mm

COVER MATERIAL: ALUMINUM ALLOYS 1050, THICKNESS: 2.0mm

FINISH: ALUMINUM ANODIC TREATMENT

TOLERANCE: Length±3mm, Width±2mm, Height±2mm, Thickness±0.1mm

水平X形彎頭 (HORIZONTAL CROSS ELBOW)

1 水平X形彎頭 (HORIZONTAL CROSS ELBOW)

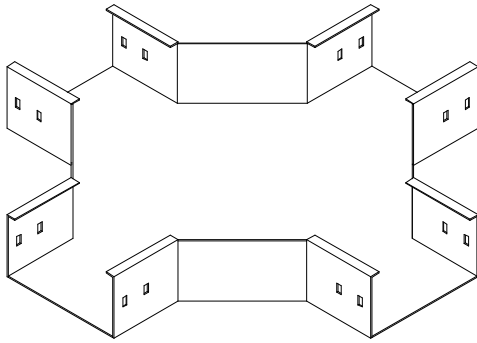

2 水平X形彎頭蓋板 (HORIZONTAL CROSS ELBOW COVER)

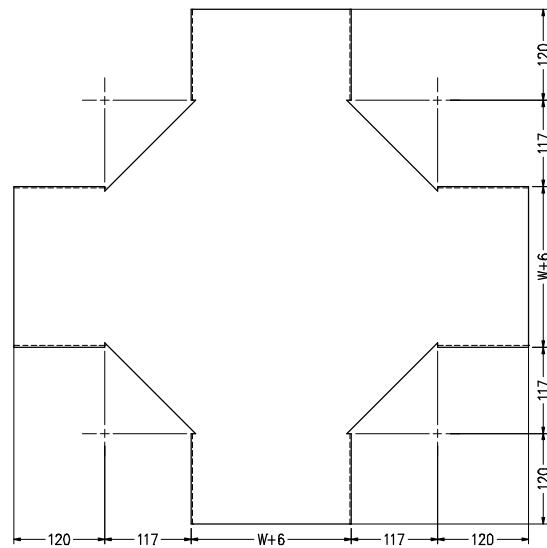
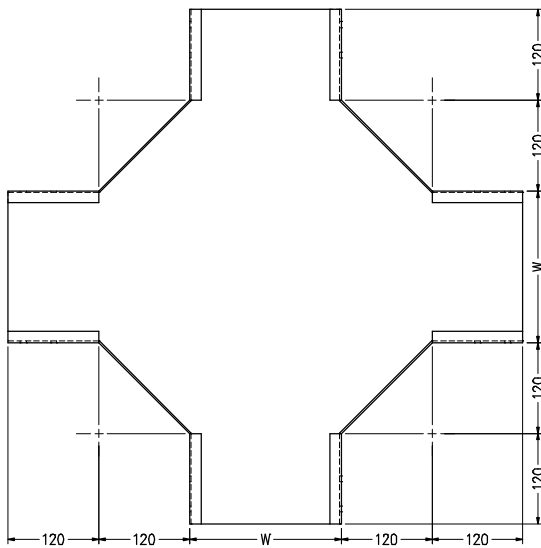
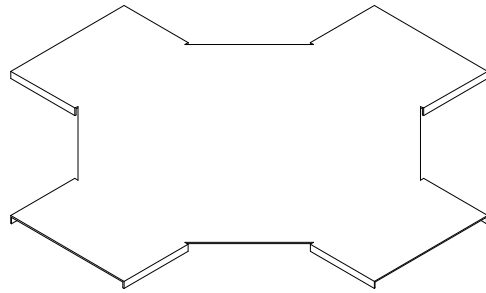

寬度 (W)	高度 (H)	半徑 (R)
100	100	120
200		
300		
400		
500		
600		
700		
800		
900		
1000		

線槽材質：鋁合金 1050，厚度：2.0mm

蓋板材質：鋁合金 1050，厚度：2.0mm

表面處理：陽極處理

公差範圍：長(L)±3mm，寬(W)±2mm，高(H)±2mm，厚(t)±0.1mm

TRAY MATERIAL: ALUMINUM ALLOYS 1050, THICKNESS: 2.0mm

COVER MATERIAL: ALUMINUM ALLOYS 1050, THICKNESS: 2.0mm

FINISH: ALUMINUM ANODIC TREATMENT

TOLERANCE: Length±3mm, Width±2mm, Height±2mm, Thickness±0.1mm

垂直上升 90° 彎頭 (VERTICAL INSIDE 90° ELBOW)

1 垂直上升 90° 彎頭 (VERTICAL INSIDE 90° ELBOW)

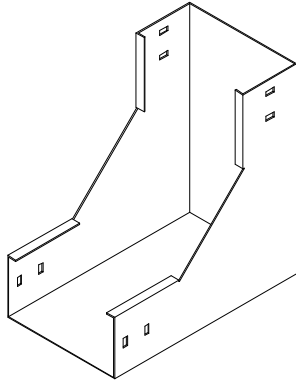

2 垂直上升 90° 彎頭蓋板 (VERTICAL INSIDE 90° ELBOW COVER)

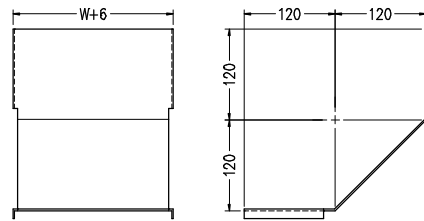
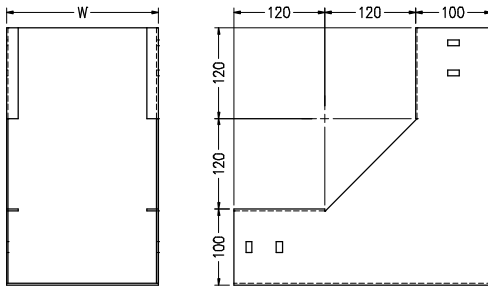
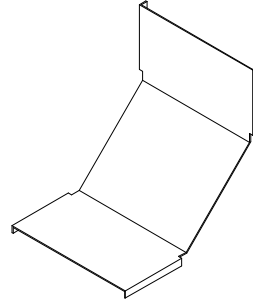

寬度 (W)	高度 (H)	半徑 (R)
100	100	120
200		
300		
400		
500		
600		
700		
800		
900		
1000		

線槽材質：鋁合金 1050，厚度：2.0mm
 蓋板材質：鋁合金 1050，厚度：2.0mm
 表面處理：陽極處理
 公差範圍：長(L)±3mm，寬(W)±2mm，高(H)±2mm，厚(t)±0.1mm
 TRAY MATERIAL: ALUMINUM ALLOYS 1050, THICKNESS: 2.0mm
 COVER MATERIAL: ALUMINUM ALLOYS 1050, THICKNESS: 2.0mm
 FINISH: ALUMINUM ANODIC TREATMENT
 TOLERANCE: Length±3mm, Width±2mm, Height±2mm, Thickness±0.1mm

垂直上升 45° 彎頭 (VERTICAL INSIDE 45° ELBOW)

1 垂直上升 45° 彎頭 (VERTICAL INSIDE 45° ELBOW)

2 垂直上升 45° 彎頭蓋板 (VERTICAL INSIDE 45° ELBOW COVER)

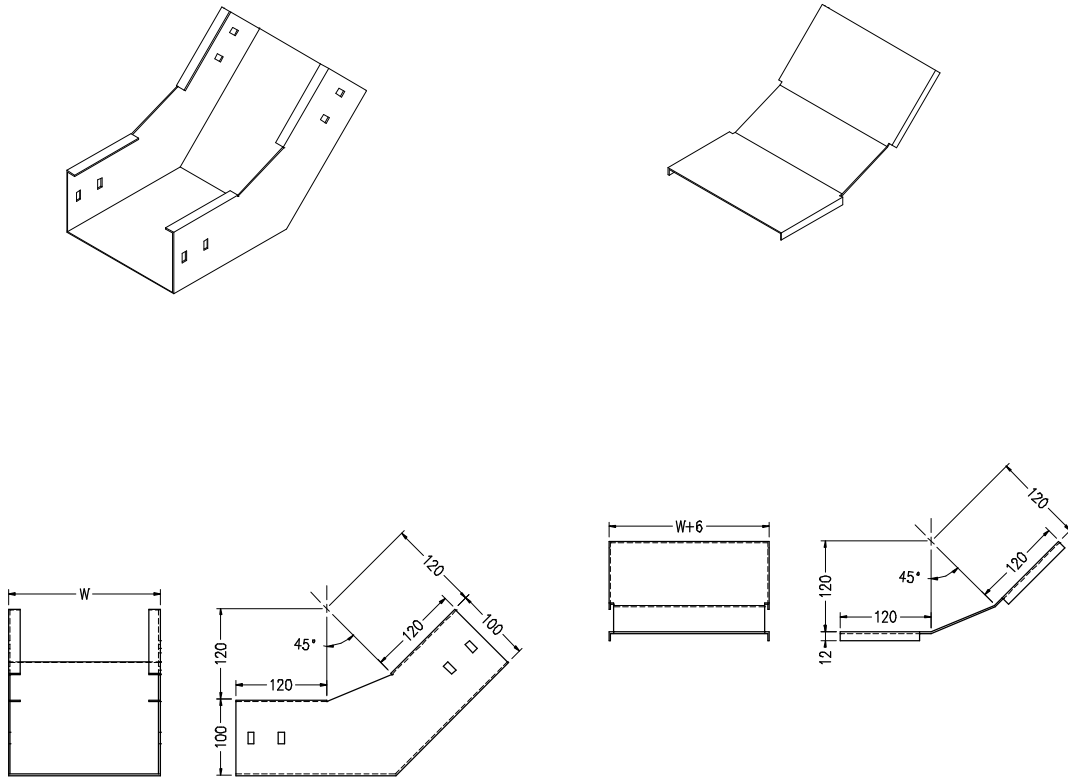

寬度 (W)	高度 (H)	半徑 (R)
100	100	120
200		
300		
400		
500		
600		
700		
800		
900		
1000		

線槽材質：鋁合金 1050, 厚度：2.0mm
 蓋板材質：鋁合金 1050, 厚度：2.0mm
 表面處理：陽極處理
 公差範圍：長(L)±3mm, 寬(W)±2mm, 高(H)±2mm, 厚(t)±0.1mm
 TRAY MATERIAL: ALUMINUM ALLOYS 1050, THICKNESS: 2.0mm
 COVER MATERIAL: ALUMINUM ALLOYS 1050, THICKNESS: 2.0mm
 FINISH: ALUMINUM ANODIC TREATMENT
 TOLERANCE: Length±3mm, Width±2mm, Height±2mm, Thickness±0.1mm

垂直下降 90° 彎頭 (VERTICAL OUTSIDE 90° ELBOW)

1 垂直下降 90° 彎頭 (VERTICAL OUTSIDE 90° ELBOW)

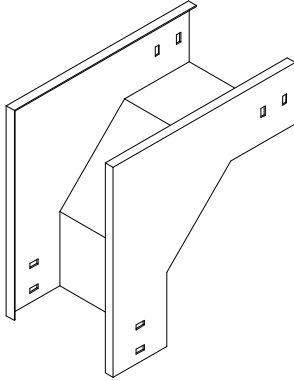

2 垂直下降 90° 彎頭蓋板 (VERTICAL OUTSIDE 90° ELBOW COVER)

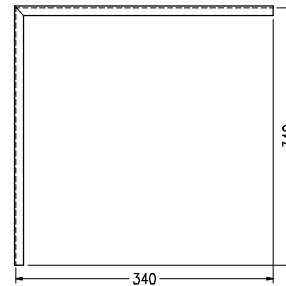
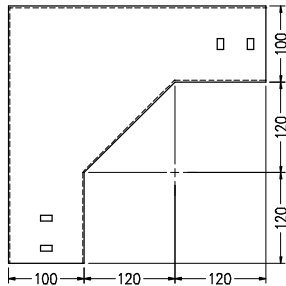
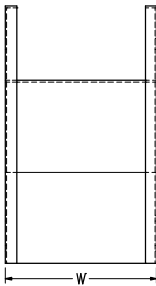
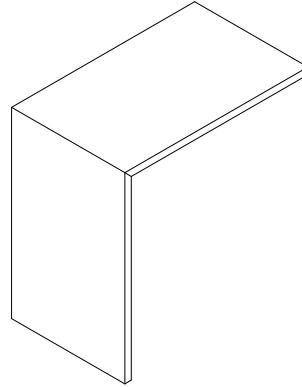

寬度 (W)	高度 (H)	半徑 (R)
100	100	120
200		
300		
400		
500		
600		
700		
800		
900		
1000		

線槽材質：鋁合金 1050，厚度：2.0mm
 蓋板材質：鋁合金 1050，厚度：2.0mm
 表面處理：陽極處理
 公差範圍：長(L)±3mm，寬(W)±2mm，高(H)±2mm，厚(t)±0.1mm
 TRAY MATERIAL: ALUMINUM ALLOYS 1050, THICKNESS: 2.0mm
 COVER MATERIAL: ALUMINUM ALLOYS 1050, THICKNESS: 2.0mm
 FINISH: ALUMINUM ANODIC TREATMENT
 TOLERANCE: Length±3mm, Width±2mm, Height±2mm, Thickness±0.1mm

垂直下降 45° 彎頭 (VERTICAL OUTSIDE 45° ELBOW)

1 垂直下降 45° 彎頭 (VERTICAL OUTSIDE 45° ELBOW)

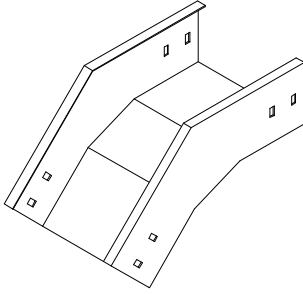

2 垂直下降 45° 彎頭蓋板 (VERTICAL OUTSIDE 45° ELBOW COVER)

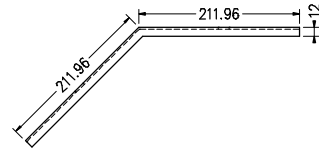
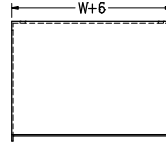
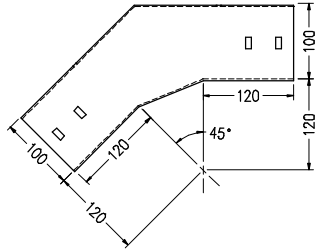
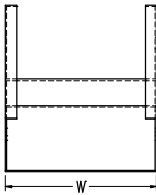
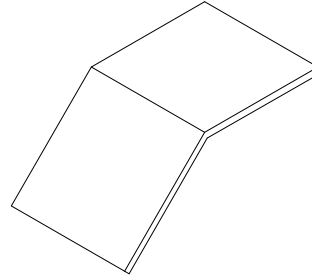

寬度 (W)	高度 (H)	半徑 (R)
100	100	120
200		
300		
400		
500		
600		
700		
800		
900		
1000		

線槽材質：鋁合金 1050，厚度：2.0mm
 蓋板材質：鋁合金 1050，厚度：2.0mm
 表面處理：陽極處理
 公差範圍：長(L)±3mm，寬(W)±2mm，高(H)±2mm，厚(t)±0.1mm
 TRAY MATERIAL: ALUMINUM ALLOYS 1050, THICKNESS: 2.0mm
 COVER MATERIAL: ALUMINUM ALLOYS 1050, THICKNESS: 2.0mm
 FINISH: ALUMINUM ANODIC TREATMENT
 TOLERANCE: Length±3mm, Width±2mm, Height±2mm, Thickness±0.1mm

左偏異徑接頭 (LEFT REDUCER ELBOW)

1 左偏異徑接頭 (LEFT REDUCER ELBOW)

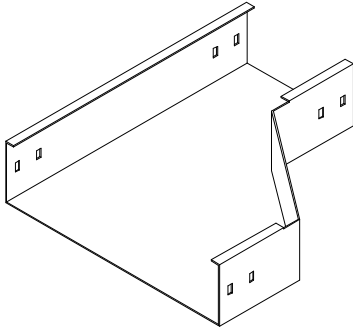

2 左偏異徑接頭蓋板 (LEFT REDUCER ELBOW COVER)

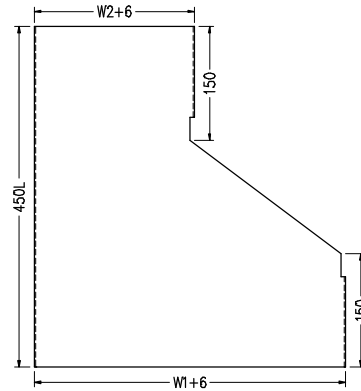
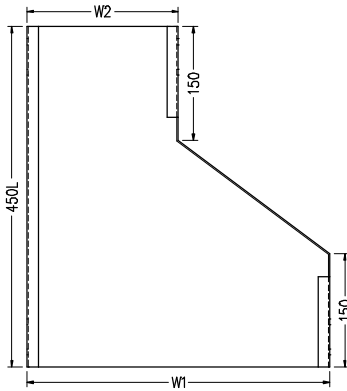
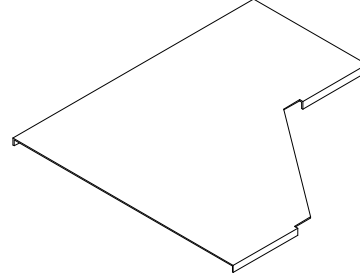

寬度(W1)	寬度(W2)	高度 (H)
300	200	100
400	200	
	300	
500	200	
	300	
	400	
600	200	
	300	
	400	
	500	

線槽材質：鋁合金 1050，厚度：2.0mm
 蓋板材質：鋁合金 1050，厚度：2.0mm
 表面處理：陽極處理
 公差範圍：長(L)±3mm，寬(W)±2mm，高(H)±2mm，厚(t)±0.1mm
 TRAY MATERIAL: ALUMINUM ALLOYS 1050, THICKNESS: 2.0mm
 COVER MATERIAL: ALUMINUM ALLOYS 1050, THICKNESS: 2.0mm
 FINISH: ALUMINUM ANODIC TREATMENT
 TOLERANCE: Length±3mm, Width±2mm, Height±2mm, Thickness±0.1mm

右偏異徑接頭 (RIGHT REDUCER ELBOW)

1 右偏異徑接頭 (RIGHT REDUCER ELBOW)

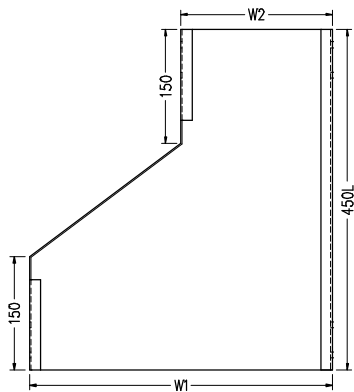
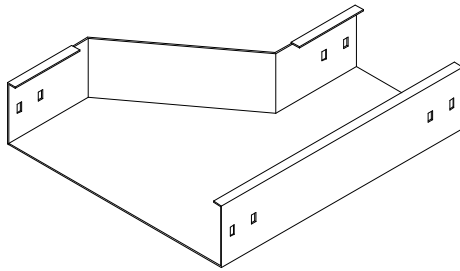

2 右偏異徑接頭蓋板 (RIGHT REDUCER ELBOW COVER)

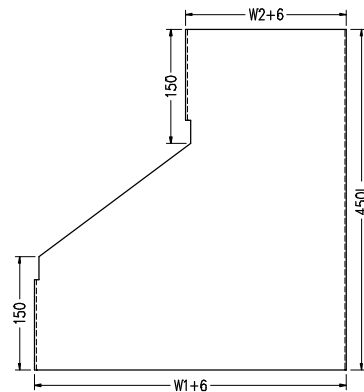
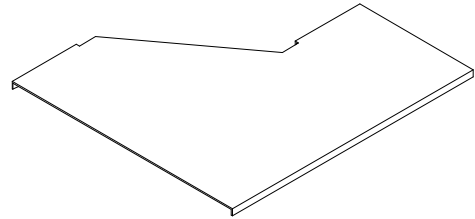

寬度(W1)	寬度(W2)	高度 (H)
300	200	100
400	200	
	300	
500	200	
	300	
	400	
600	200	
	300	
	400	
	500	

線槽材質：鋁合金 1050，厚度：2.0mm

蓋板材質：鋁合金 1050，厚度：2.0mm

表面處理：陽極處理

公差範圍：長(L)±3mm，寬(W)±2mm，高(H)±2mm，厚(t)±0.1mm

TRAY MATERIAL: ALUMINUM ALLOYS 1050, THICKNESS: 2.0mm

COVER MATERIAL: ALUMINUM ALLOYS 1050, THICKNESS: 2.0mm

FINISH: ALUMINUM ANODIC TREATMENT

TOLERANCE: Length±3mm, Width±2mm, Height±2mm, Thickness±0.1mm

◆ 中間異徑接頭 (CENTER REDUCER ELBOW)

1 中間異徑接頭 (CENTER REDUCER ELBOW)

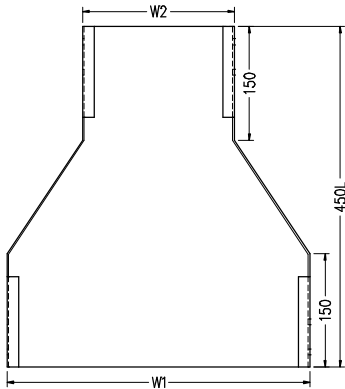
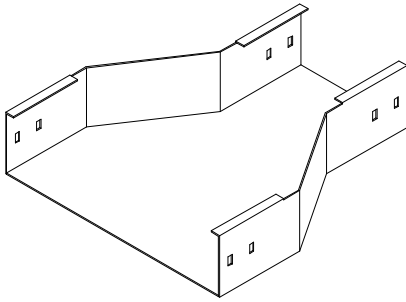

2 中間異徑接頭蓋板 (CENTER REDUCER ELBOW COVER)

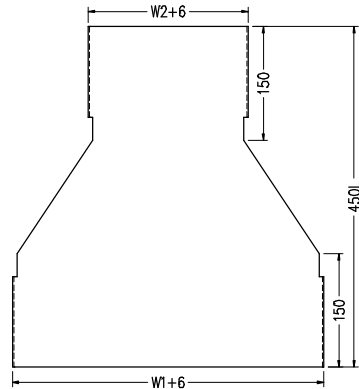
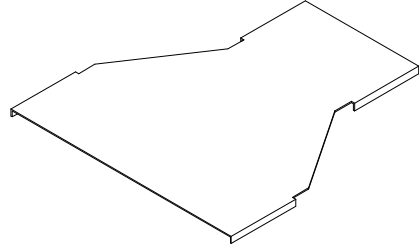

寬度(W1)	寬度(W2)	高度 (H)
300	200	100
400	200	
	300	
500	200	
	300	
	400	
600	200	
	300	
	400	
	500	

線槽材質：鋁合金 1050，厚度：2.0mm

蓋板材質：鋁合金 1050，厚度：2.0mm

表面處理：陽極處理



公差範圍：長(L)±3mm，寬(W)±2mm，高(H)±2mm，厚(t)±0.1mm

TRAY MATERIAL: ALUMINUM ALLOYS 1050, THICKNESS: 2.0mm

COVER MATERIAL: ALUMINUM ALLOYS 1050, THICKNESS: 2.0mm

FINISH: ALUMINUM ANODIC TREATMENT

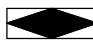
TOLERANCE: Length±3mm, Width±2mm, Height±2mm, Thickness±0.1mm

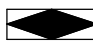
-  終端封板 (BLIND END COVER)
-  線槽連接片 (CONNECTOR)
-  垂直可調連接片 (ADJUSTABLE VERTICAL CONNECTOR)
-  接地銅片 (COPPER GROUNDING PEICES)

1 終端封板 (BLIND END COVER)

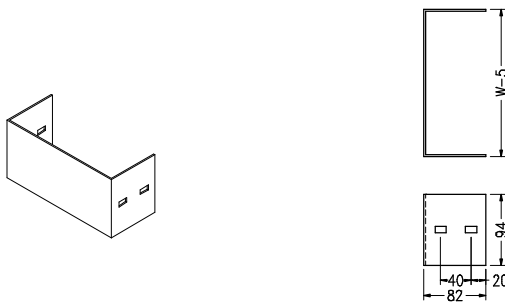

寬度 (W)	高度 (H)	厚度 (t)
100	100	2.0
200		
300		
400		
500		
600		
700		
800		
900		
1000		

材質: 鋁合金 1050
 表面處理: 陽極處理
 MATERIAL: ALUMINUM ALLOYS 1050
 FINISH: ALUMINUM ANODIC TREATMENT

2 線槽連接片 (CONNECTOR)

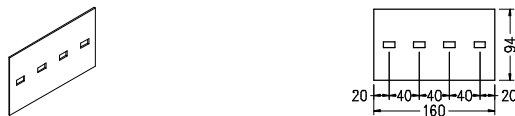

材質: 鋁合金 1050
 表面處理: 陽極處理
 MATERIAL: ALUMINUM ALLOYS 1050
 FINISH: ALUMINUM ANODIC TREATMENT

高度 (H)	厚度 (t)
100	2.0

3 垂直可調連接片 (ADJUSTABLE VERTICAL CONNECTOR)

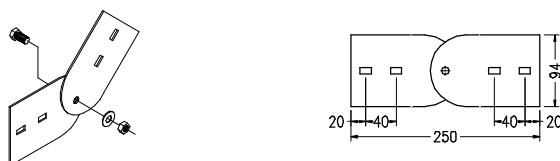



材質: 鋁合金 1050
 表面處理: 陽極處理
 MATERIAL: ALUMINUM ALLOYS 1050
 FINISH: ALUMINUM ANODIC TREATMENT

高度 (H)	厚度 (t)
100	2.0

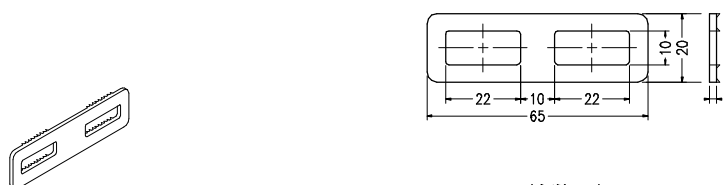
4 接地銅片 (COPPER GROUNDING PEICES)

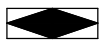

材質: 銅
 厚度 (t): 2.0mm
 MATERIAL: COPPER
 THICKNESS: 2.0mm

-  蓋板固定夾 (COVER CLAMP)
-  馬車螺絲 (SQUARE NECK BOLT)
-  塑膠夾板 (PLASTIC CUP)

1 蓋板固定夾 (COVER CLAMP)

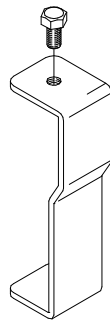
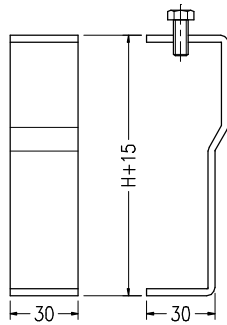

材質: 不銹鋼板 SUS304
 厚度 (t): 2.0±0.2mm
 表面處理: 無
 MATERIAL: STAINLESS STEEL SUS304
 THICKNESS: 2.0±0.2mm
 FINISH: NONE

2 馬車螺絲 (SQUARE NECK BOLT)

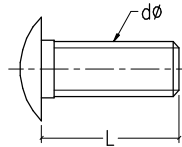
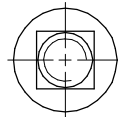
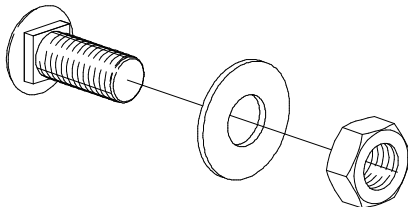

材質: 不銹鋼 (SUS304)
 尺寸: 5/16"x3/4"L
 MATERIAL: STAINLESS STEEL (SUS304)
 DIMENSION: 5/16"x3/4"L

3 塑膠夾板 (PLASTIC CUP)

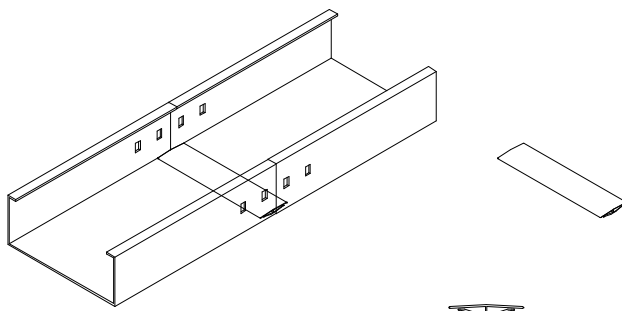

寬度 (W)
100
200
300
400
500
600
700
800
900
1000

材質: 塑膠
 MATERIAL: PLASTIC